

## Map to Julie & Bill's Place

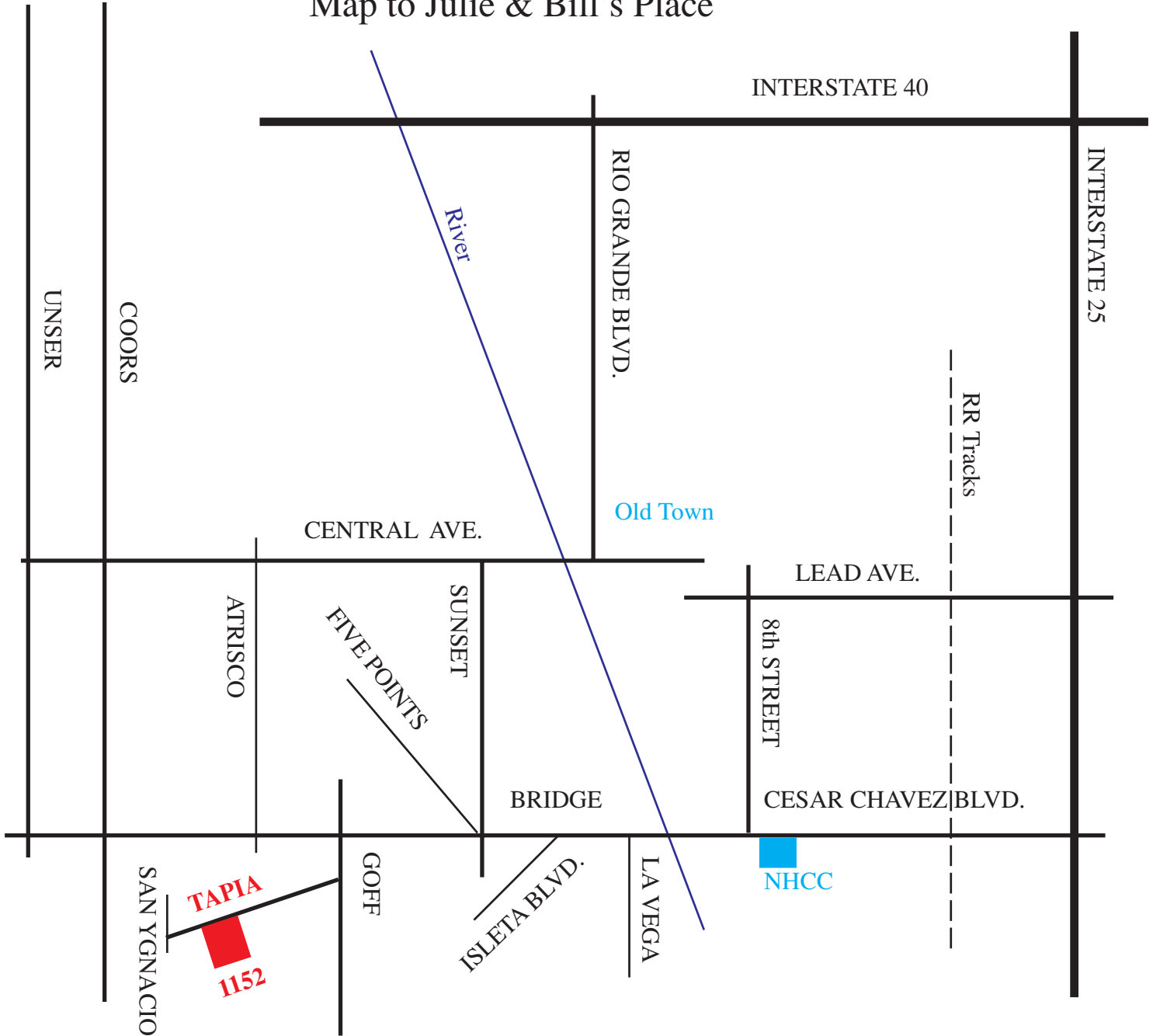

From I-25: Exit Avenida Cezar Chavez. Go West. It eventually becomes Bridge Street. Cross the railroad bridge, then the Rio Grande bridge. At fourth traffic light past the river, turn left on Goff, then take an immediate right onto Tapia. Go about a block and a half, until you see an adobe wall on the left. That's us --

1152 TAPIA BLVD. SW, 242-7176

From North Valley: Rio Grande Blvd. south to Central. West on Central. First light after bridge is Sunset. Go south on Sunset to Bridge. West on Bridge to Goff. Follow directions above.

From West Side: Coors or Unser south to Bridge St. East on Bridge to Goff (2nd light). Follow directions above.